



C.B.R. di CECCATO RENATO RENZO & C. S.n.c.

Via signoria, 7 - 35010 ARSEGO di

S. Giorgio delle Pertiche (PD) Italy

TEL. 0039 / 0495742014 - FAX 0039 / 0495742766

Internet www.cbrceccato.it - E-Mail: info@cbrceccato.com

Instruction and maintenance manual 2 Rotors Rotative Hay Tedder



Mod.: Montagna MT. 2,00
Montagna MT 2,00 c/andatore with windrowing fitt.
Normale MT 2,40
Normale MT 2,60
Normale MT 2,60 c/andatore with windrowing fitt.
Special MT 3,10
Special MT 3,10 c/andatore with windrowing fitt.



Congratulations on having chosen one of our articles.

This booklet is an integral and essential part of the product and contains all the necessary pieces of information to the correct operating and maintenance of your hay tedder.

Read carefully these instructions, before starting working.

Keep this booklet with care: if lost or damaged, ask for a new copy, stating the model of the hay tedder and its date of purchase.

In case of contention, the Italian text will be the valid one.

Guarantee

The machine is guaranteed a season from the date of purchase.

The seller will replace or to his choice will repair free the goods, which to his unquestionable judgment have resulted defective in the material or in the manufacturing during a normal and appropriate use within and not over the time prescribed by this guarantee.

The guarantee does not include manpower and consignment expenses.

The guarantee is only applied whenever:

- The buyer gives a written detailed note and a satisfactory test of the defect within 8 days from the date in which the defect manifested.
- Goods are sent to us at buyer's expenses, in a carefully package and complete with a detailed technical relationship.
- The customer refunds the transport expenses if our skilled operators repair the machine at the customer's installation.

The guarantee is null whenever:

- The machine is used differently from what explained in this manual.
- Modifications are made or non-original spare parts are used.

Check the machine when delivered.

C.B.R. di Ceccato S.n.c. declines every responsibility for damages on things and people due to tamperings, use of non-original spare parts, inobservance of what explained in this manual.

Our advertising material is C.B.R. Ceccato's copyright: total or partial reproduction without written permission is forbidden.

Place of jurisdiction: Padua (Italy).

CE DECLARATION OF CONFORMITY

We declare that the machine described into this use and maintenance handbook conforms to the security essential safety according to the CE Directive 2006/42/CE and its subsequent amendments in force up to today.

DICHIARAZIONE di CONFORMITA' CE

Si dichiara che il prodotto descritto nel presente manuale uso e manutenzione e' conforme ai requisiti di sicurezza della Direttiva Macchine 2006/42/CE e sue integrazioni.

Arsego, January 2nd, 2018

INDEX

	Page
CE DECLARATION OF CONFORMITY	3
1. TECHNICAL FEATURES	5
2. COMPONENTS	6
3. PRE-ASSEMBLY DIRECTIONS	7
4. WINDROWER FITTING PRE-ASSEMBLY DIRECT.	7
5. CONNECTION TO THE TRACTOR	8
6. TRANSPORT	8
7. USE OF THE SPREADER IN SAFETY CONDITIONS	8
8. WINTER STORAGE	10
9. PIECES OF INFORMATION ABOUT THE NOISE	10
10. MAINTENANCE AND SPARE PARTS	10

This use and maintenance handbook is component of the rotative spreader. Preserve it carefully. It is necessary to follow all the instructions given, which must always be available to the operator for easy reference. It may happen that advertising material shows pictures of machinery without protective shields. We remind you, that it is obligatory to use the machinery with the assembled safety guards.

1. TECHNICAL FEATURES

The Hay tedder has been built with the aim of spreading, airing and turning the forage. No other use with other different products is foreseen.

The models MONTAGNA MT. 2,00, NORMALE MT. 2,60 and SPECIAL MT. 3,10 may be available with windrower fitting.

Every machine's P.T.O. Shaft minimum power is 10 kW (\approx HP 15).

In this page are described the technical features for each model:

Modello	Largh. Lavoro	Giranti	Braccia / girante	Denti	Ruote piroett.	Peso	Largh. Trasp.
Model	Working Width	Rotors	Arms / Rotor	Teeth	Pirouett. Wheels	Weight	Transp. Width
	MT	No.	No.	No.		Kgs.	mm.
Montagna	2,00	02	05	10	13.500-6	125	1250
Montagna with windrower	2,00	02	05	10	13.500-6	160	1500
Normale	2,40	02	06	12	13.500-6	135	1600
Normale	2,60	02	06	12	13.500-6	140	1600
Normale with windrower	2,60	02	06	12	13.500-6	175	1600
Special	3,10	02	06	12	15.600-6	170	2100
Special with windrower	3,10	02	06	12	15.600-6	210	2100

2. COMPONENTS

The main components of the windrower are:

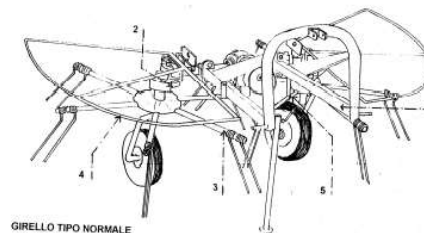

1. 1. 3 POINT LINKAGE WITH SUPPORTING LEG
2. CENTRAL SPREADER GROUP
3. ARMS WITH SPRINGS
4. PROTECTIVE BARRIER
5. NUTS AND BOLTS AND ASSEMBLING FITTINGS

The models Normale with Windrower and Special with Windrower have got also the following components:

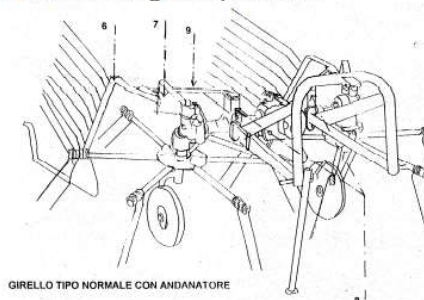

6. WINDROW FITTING WITH SPRINGS AND CLOTH
7. ADJUSTING SUPPORT
8. CENTRAL BOLTS OR STIRRUPS
9. CONNECTING ELEMENTS

3. PRE-ASSEMBLY DIRECTIONS

Fix the 3 point linkage to the central spreader by means of the included 14 MA bolts.

The model Montagna is equipped with fixed arms for transport, too. Fix rigidly with 12 MA screws the four right arms and the four left arms.

For models Normale and Special fix with 12 MA screws the two left arms on the side in which two proper elements are joined. Fix the security pin. The two left arms are removable for transport.

On the other side, fix the other removable arm with 12 MA screw, in a centered position in comparison to the other ones. Fix the security pin.

Be careful at using the left and the right arms correctly. Assemble the protective barriers by means of 10 MA bolts.

WARNING: Fill the central box with 01 (one) Kg. of oil model SAE 140 or equivalent ones.

The use of the tedder, without having inserted the oil in the central box, involves the breakup of the same and its consequent substitution.

To use the PTO Shaft, follow the instructions given in the PTO shaft Use and Maintenance Handbook.

4. WINDROWER FITTING PRE-ASSEMBLY DIRECTIONS

Fix the 3 point linkage to the central spreader frame and fix the stirrups with 14 MA bolts. Assemble the adjusting supports and the windrow fitting on the axle wheels by means of the proper screws.

Assemble the connecting elements with their screws. Assemble the arms with their screws.

For winter storage, put the spreader in a sheltered place and fit it in order to avoid movings due to accidental push. Be careful at springs. Put them to the ground to avoid risk of damage to people. At the resumption of works, find it in perfect conditions in an advantage.

5. CONNECTION TO THE TRACTOR

Link the spreader to the tractor by means of the 3 point linkage and the 3 central stirrups having hole Ø 22 mms.

Take the supporting leg away. Verify that the P.T.O. Shaft max. r.p.m. number is equal or lesser than the max. allowed 540 r.p.m.

6. TRANSPORT

Take the P.T.O. Shaft away. Lift the protective barrier and fix them with the security pin. Disassemble the arms and put them into their housing. Fix with screws.

Fix the possibility of movement of the rotor by means of the proper pin.

The transport is possible only if the machine is lifted up.

The user has to follow the highway code in force in the area of employment.

Be careful at spring!

In case of doubt about the maintenance to perform, get in touch for explanations with the manufacturer or the area dealer, before carrying out any maintenance.

7. USE OF THE SPREADER IN SAFETY CONDITIONS

Follow carefully the instructions given in this use and maintenance manual. Do not change part of the machine, do not absolutely remove the protective barriers.

Only skilled operators and in any case only adults must use the rotative spreader.

Be sure the machine is complete in all its parts and in good working conditions, before starting working. Check it and if necessary, change the damaged parts before starting working.

Take care that no one (people, children, animals) should be with in the range of action, of the machine, while it is working.

Perform these actions **before** connecting the P.T.O. Shaft according to its constructor instructions.

Assemble the arms, free the rotor, put the pin into the working position, lower the protective barrier and check the correct fixing of all parts of the machine. Adjust the windrow fitting position.

Connect the P.T.O. Shaft according to its manufacturer directions.

Have the movement begun. Put the wheels to the ground. Tilt the spreader letting the 3 point down, until tines skim over the ground.

WARNING:

- 1. Do not cause sharp crashes to the ground.**
- 2. Do not get near the ground too much, in order to avoid the tine breaking.**
- 3. Keep hands, feet and clothing away from moving parts.**
- 4. Be careful at using the machine on uneven grounds, in order to avoid crashes. Crashes may cause the throwing of stones and other dangerous materials in the surroundings.**
- 5. No one has to be near the machine, while it is in motion and with the engine on. This situation is not necessary to the correct working of the spreader, but it is safer.**

While working, the operator has to check that no one gets near the working area of the spreader.

The operator must not get near the machine down, while it is working: moving parts are dangerous, because tines are tapered to a point.

Remember: caution is the best safety measure against any accident.

8. WINTER STORAGE

For winter storage or if the machine is not in use for a long period, put the rotative spreader in a sheltered place and fit it in order to avoid movings due to accidental push. Be careful at springs. At the resumption of work, find it in perfect conditions is an advantage.

9. INFORMATION ABOUT THE NOISE

To the ear of the operator, the acoustic noise is lower than 70 dB (A).

10. MAINTENANCE AND SPARE PARTS

Before every operation, you must always:

1. Disconnect the P.T.O.
2. Plug the handbrake in
3. Switch the engine off

Before starting working and after the use of your rotative spreader, check the possible damaged parts and replace them.

To order the spare parts: please specify the model of tedder in your possession: Please make request to the manufacturer, as far as unlisted spare parts concerns.

Every maintenance and/or replacement must be performed by skilled operators.

The customer, who authorized them, is anyway responsible for the residual risk.

TYRE PRESSURE

Check periodically the tyre pressure: it must be about 1,8-2,5 BAR

ROTATIVE SPREADER MODEL NORMALE
GIRELLO NORMALE
TAV. 1

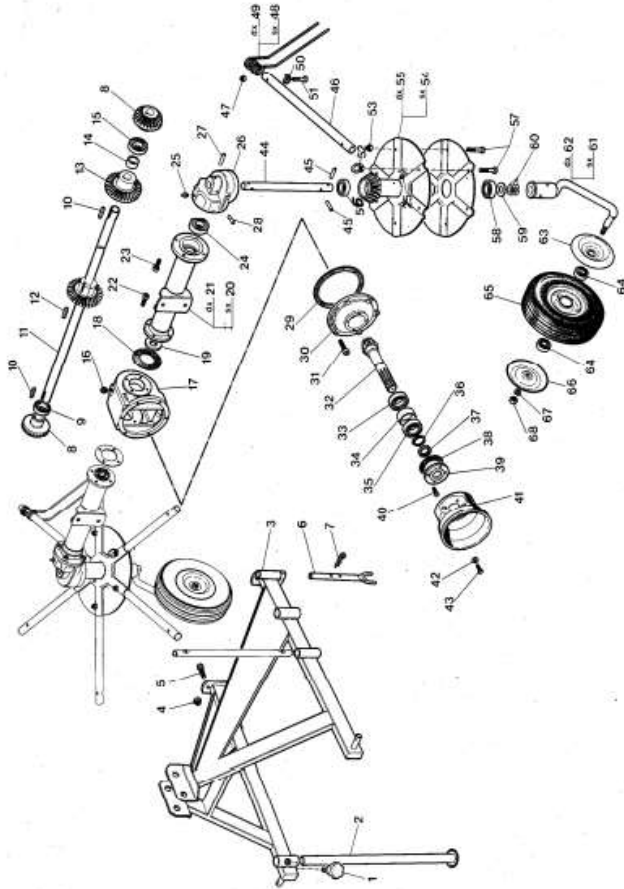

ROTATIVE SPREADER MODEL SPECIAL
GIRELLO SPECIAL
TAV. 2

